

# ISLA VERDE OF WELLINGTON COMMERCIAL PLAT

BEING A REPLAT OF TRACT E, ISLA VERDE OF WELLINGTON, AS RECORDED IN PLAT BOOK 110, PAGES 132 THROUGH 138, TOGETHER WITH PORTIONS OF TRACT L AND PARCEL A, ISLA VERDE OF WELLINGTON RESIDENTIAL, AS RECORDED IN PLAT BOOK 111, PAGES 200 THROUGH 204, ALL OF THE PUBLIC RECORDS OF PALM BEACH COUNTY, FLORIDA, LYING IN SECTIONS 6 AND 7, TOWNSHIP 44 SOUTH, RANGE 42 EAST, VILLAGE OF WELLINGTON, PALM BEACH COUNTY, FLORIDA

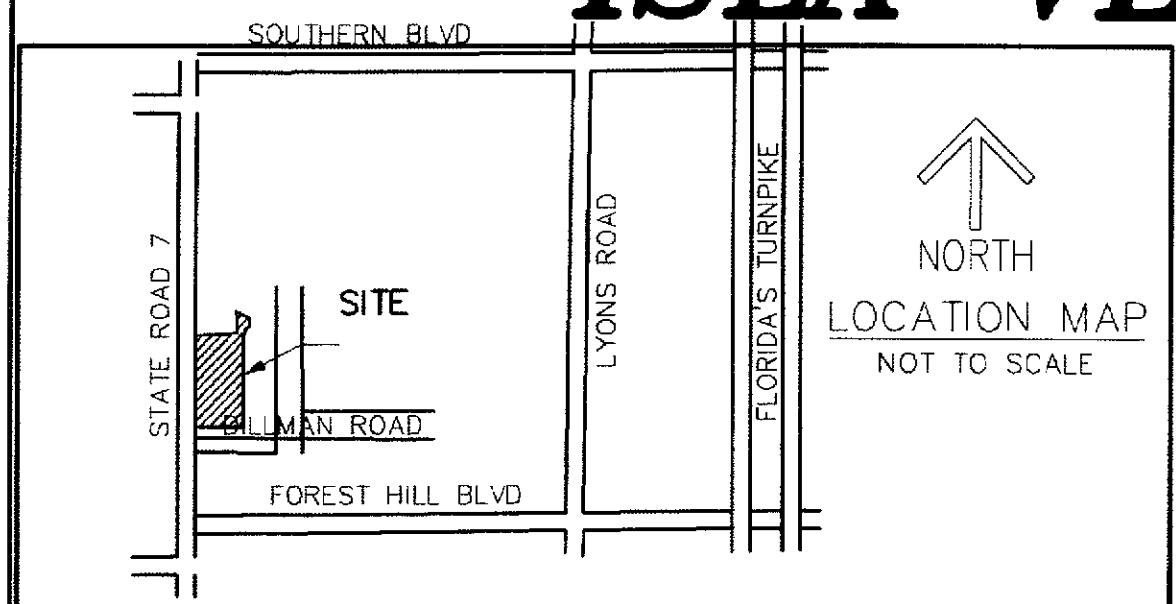

"NOTICE" THIS PLAT, AS RECORDED IN ITS GRAPHIC FORM, IS THE OFFICIAL DEPICTION OF THE SUBDIVIDED LANDS DESCRIBED HEREIN AND WILL IN NO CIRCUMSTANCES BE SUPPLANTED IN AUTHORITY BY ANY OTHER GRAPHIC OR DIGITAL FORM OF THE PLAT. THERE MAY BE ADDITIONAL RESTRICTIONS THAT ARE NOT RECORDED ON THIS PLAT THAT MAY BE FOUND IN THE PUBLIC RECORDS OF PALM BEACH COUNTY.

THIS INSTRUMENT PREPARED BY  
DAVID P. LINDLEY  
OF  
**CAULFIELD and WHEELER, INC.**  
SURVEYORS - ENGINEERS - PLANNERS  
7301-A WEST PALMETTO PARK ROAD, SUITE 100A  
BOCA RATON, FLORIDA 33433 - (561)392-1991  
OCTOBER - 2011

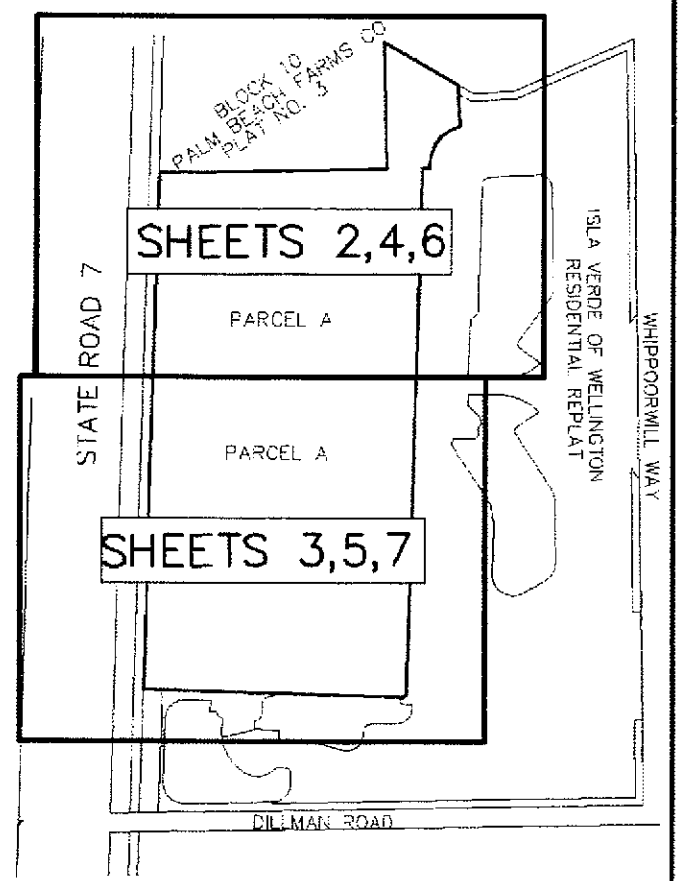
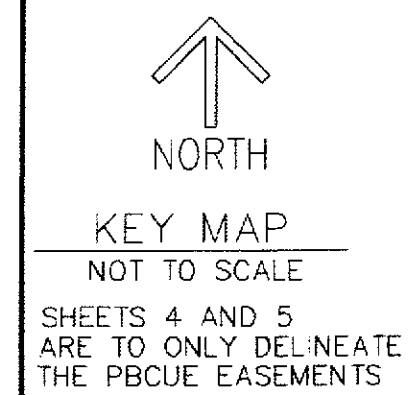

STATE OF FLORIDA  
COUNTY OF PALM BEACH  
THIS PLAT WAS FILED FOR  
RECORD AT 2:52 P.M.  
THIS 27 DAY OF March  
A.D. 2012 AND DULY RECORDED  
IN PLAT BOOK 116 ON  
PAGES 62 AND 63  
SHARON R. BOCK  
CLERK AND COMPTROLLER  
By: [Signature]  
DEPUTY CLERK

SHEET 1 OF 7

**TABULAR AREA DATA**

TOTAL AREA THIS PLAT	998,142 SQUARE FEET	22,914 ACRES
AREA OF PARCEL A	952,020 SQUARE FEET	21,855 ACRES
AREA OF PARCEL B	46,122 SQUARE FEET	1,059 ACRES

**DEDICATION AND RESERVATIONS:**  
KNOW ALL MEN BY THESE PRESENTS THAT SHOPPES AT ISLA VERDE LTD., A FLORIDA LIMITED PARTNERSHIP AND PEBB ENTERPRISES ROYAL PALM BEACH PROPERTY, LLC, A FLORIDA LIMITED LIABILITY COMPANY, OWNERS OF THE LAND SHOWN HEREON AS ISLA VERDE OF WELLINGTON COMMERCIAL PLAT, BEING A REPLAT OF TRACT E, ISLA VERDE OF WELLINGTON, AS RECORDED IN PLAT BOOK 110, PAGES 132 THROUGH 138, TOGETHER WITH PORTIONS OF TRACT L AND PARCEL A, ISLA VERDE OF WELLINGTON RESIDENTIAL, AS RECORDED IN PLAT BOOK 111, PAGES 200 THROUGH 204, ALL OF THE PUBLIC RECORDS OF PALM BEACH COUNTY, FLORIDA, LYING IN SECTIONS 6 AND 7, TOWNSHIP 44 SOUTH, RANGE 42 EAST, VILLAGE OF WELLINGTON, PALM BEACH COUNTY, FLORIDA, BEING MORE PARTICULARLY DESCRIBED AS FOLLOWS:

BEGINNING AT THE SOUTHWEST CORNER OF SAID TRACT E, ISLA VERDE AT WELLINGTON; THENCE N01°35'48"E ALONG THE WEST LINE THEREOF, A DISTANCE OF 1,356.28 FEET TO THE NORTHWEST CORNER OF SAID TRACT E; THENCE N89°03'15"E ALONG THE NORTH LINE OF SAID TRACT E, A DISTANCE OF 600.13 FEET; THENCE N00°58'38"W ALONG THE WEST LINE OF SAID ISLA VERDE OF WELLINGTON RESIDENTIAL, A DISTANCE OF 329.95 FEET TO THE NORTHWEST CORNER OF TRACT L OF SAID ISLA VERDE OF WELLINGTON RESIDENTIAL; THENCE S60°22'08"E ALONG THE NORTH LINE OF SAID ISLA VERDE OF WELLINGTON RESIDENTIAL, A DISTANCE OF 221.94 FEET TO THE NORTHWEST CORNER OF TRACT L OF ISLA VERDE OF WELLINGTON RESIDENTIAL REPLAT, AS RECORDED IN PLAT BOOK 111, PAGES 200 THROUGH 204, OF THE PUBLIC RECORDS OF PALM BEACH COUNTY, FLORIDA; THENCE S02°46'58"E ALONG THE WEST LINE OF SAID ISLA VERDE OF WELLINGTON RESIDENTIAL REPLAT, A DISTANCE OF 108.60 FEET TO THE POINT OF CURVE OF A NON TANGENT CURVE TO THE LEFT, OF WHICH THE RADIUS POINT LIES S13°26'03"E, A RADIAL DISTANCE OF 102.00 FEET; THENCE SOUTHWESTERLY ALONG THE ARC, THROUGH A CENTRAL ANGLE OF 74°55'24", A DISTANCE OF 133.38 FEET; THENCE S01°38'33"W, A DISTANCE OF 13.18 FEET; THENCE S88°52'10"W, A DISTANCE OF 19.25 FEET; THENCE S01°36'16"W, A DISTANCE OF 1,381.08 FEET; THENCE S52°34'34"W, A DISTANCE OF 17.43 FEET TO THE POINT OF CURVE OF A NON TANGENT CURVE TO THE LEFT, OF WHICH THE RADIUS POINT LIES S40°27'35"W, A RADIAL DISTANCE OF 21.00 FEET; THENCE WESTERLY ALONG THE ARC, THROUGH A CENTRAL ANGLE OF 38°51'47", A DISTANCE OF 14.24 FEET (THE PREVIOUS SEVEN COURSES AND DISTANCES BEING ALONG THE WEST LINE OF SAID ISLA VERDE OF WELLINGTON RESIDENTIAL REPLAT); THENCE N88°24'12"W ALONG A BOUNDARY LINE OF SAID ISLA VERDE OF WELLINGTON RESIDENTIAL REPLAT, A DISTANCE OF 687.22 FEET TO THE POINT OF BEGINNING.

SAID LANDS SITUATE IN THE VILLAGE OF WELLINGTON, PALM BEACH COUNTY, FLORIDA, CONTAINING 998,142 SQUARE FEET OR 22,914 ACRES, MORE OR LESS.

AND DO HEREBY DEDICATE AS FOLLOWS:

1. PARCEL A, AS SHOWN HEREON IS HEREBY RESERVED BY SHOPPES AT ISLA VERDE LTD., A FLORIDA LIMITED PARTNERSHIP, THEIR SUCCESSORS AND ASSIGNS, FOR PURPOSES CONSISTENT WITH THE CURRENT VILLAGE OF WELLINGTON ZONING CODE AND IS THE PERPETUAL MAINTENANCE OBLIGATION OF SAID SHOPPES AT ISLA VERDE LTD., A FLORIDA LIMITED PARTNERSHIP, THEIR SUCCESSORS AND ASSIGNS, WITHOUT RECOURSE TO THE VILLAGE OF WELLINGTON, FLORIDA.

PARCEL A IS SUBJECT TO A NON-EXCLUSIVE INGRESS/EGRESS EASEMENT FOR THE OWNER OF PARCEL B, THEIR SUCCESSORS AND ASSIGNS.

THE WEST 40 FEET OF PARCEL A IS SUBJECT TO THE RESTRICTIONS SET FORTH IN OFFICIAL RECORD BOOK 20132, PAGES 740 THROUGH 744 OF THE PUBLIC RECORDS OF PALM BEACH COUNTY, FLORIDA, IN FAVOR OF THE LAKE WORTH DRAINAGE DISTRICT.

2. PARCEL B, AS SHOWN HEREON IS HEREBY RESERVED BY PEBB ENTERPRISES ROYAL PALM BEACH PROPERTY, LLC, A FLORIDA LIMITED LIABILITY COMPANY, THEIR SUCCESSORS AND ASSIGNS, FOR PURPOSES CONSISTENT WITH THE CURRENT VILLAGE OF WELLINGTON ZONING CODE AND IS THE PERPETUAL MAINTENANCE OBLIGATION OF PEBB ENTERPRISES ROYAL PALM BEACH PROPERTY, LLC, A FLORIDA LIMITED LIABILITY COMPANY, THEIR SUCCESSORS AND ASSIGNS, WITHOUT RECOURSE TO THE VILLAGE OF WELLINGTON, FLORIDA.

3. LANDSCAPE BUFFER EASEMENTS (LBE), AS SHOWN HEREON ARE HEREBY DEDICATED TO THE ISLA VERDE OF WELLINGTON MASTER ASSOCIATION, INC., ITS SUCCESSORS AND ASSIGNS, FOR LANDSCAPE BUFFER PURPOSES AND ARE THE PERPETUAL MAINTENANCE OBLIGATION OF SAID ASSOCIATION, ITS SUCCESSORS AND ASSIGNS, WITHOUT RECOURSE TO THE VILLAGE OF WELLINGTON, FLORIDA.

4. DRAINAGE EASEMENT (DE), AS SHOWN HEREON, IS HEREBY DEDICATED TO THE ISLA VERDE OF WELLINGTON MASTER ASSOCIATION, INC., ITS SUCCESSORS AND ASSIGNS, FOR ACCESS, CONSTRUCTION, OPERATION AND MAINTENANCE OF STORMWATER MANAGEMENT AND DRAINAGE FACILITIES FOR THE PURPOSE OF PERFORMING ANY AND ALL MAINTENANCE ACTIVITIES PURSUANT TO THE MAINTENANCE OBLIGATION OF SAID ASSOCIATION, ITS SUCCESSORS AND ASSIGNS, WITHOUT RECOURSE TO THE VILLAGE OF WELLINGTON, FLORIDA.

THE VILLAGE OF WELLINGTON, FLORIDA, ITS SUCCESSORS AND ASSIGNS SHALL HAVE THE RIGHT BUT NOT THE OBLIGATION TO MONITOR, INSPECT AND MAINTAIN ANY PORTION OF THE DRAINAGE SYSTEM ENCOMPASSED BY THIS PLAT WHICH IS ASSOCIATED WITH THE DRAINAGE OF PUBLIC STREETS, INCLUDING THE RIGHT TO UTILIZE FORCE MAINS, PIPES, AND ALL DRAINAGE EASEMENTS ASSOCIATED WITH SAID DRAINAGE SYSTEM, ALSO INCLUDING THE RIGHT TO INGRESS AND EGRESS OVER PARCEL A.

5. RETENTION EASEMENT (RE), AS SHOWN HEREON ARE HEREBY DEDICATED TO PEBB ENTERPRISES ROYAL PALM BEACH PROPERTY, LLC, A FLORIDA LIMITED LIABILITY COMPANY, THEIR SUCCESSORS AND ASSIGNS FOR STORMWATER MANAGEMENT, LITTORAL ZONE, FILTER MARSH AND DRAINAGE PURPOSES AND IS THE PERPETUAL MAINTENANCE OBLIGATION OF SAID ASSOCIATION, ITS SUCCESSORS AND ASSIGNS, WITHOUT RECOURSE TO THE VILLAGE OF WELLINGTON, FLORIDA.

6. PALM BEACH COUNTY UTILITY EASEMENTS (PBCUE) IDENTIFIED ON THE PLAT HEREON ARE EXCLUSIVE EASEMENTS AND ARE HEREBY DEDICATED IN PERPETUITY TO PALM BEACH COUNTY, ITS SUCCESSORS AND ASSIGNS, FOR THE INSTALLATION, OPERATION, MAINTENANCE, REPAIR, EXPANSION AND REPLACEMENT OF POTABLE WATER PIPELINES, WASTEWATER PIPELINES, RAW WATER PIPELINES, RECLAIMED WATER PIPELINES, AND RELATED APPURTENANCES. THE MAINTENANCE OF THE LAND UNDERLYING THESE EASEMENTS SHALL BE A PERPETUAL OBLIGATION OF THE PROPERTY OWNER. NO BUILDINGS, STRUCTURES, IMPROVEMENTS, TREES, WALLS OR FENCES SHALL BE INSTALLED WITHIN THESE EASEMENTS WITHOUT THE PRIOR WRITTEN APPROVAL OF THE PALM BEACH COUNTY WATER UTILITIES DEPARTMENT, ITS SUCCESSORS AND ASSIGNS.

7. LIFT STATION EASEMENT (LSE), AS SHOWN HEREON IS AN EXCLUSIVE EASEMENT AND IS HEREBY DEDICATED IN PERPETUITY TO PALM BEACH COUNTY, ITS SUCCESSORS AND ASSIGNS, FOR THE INSTALLATION, OPERATION, MAINTENANCE, REPAIR, EXPANSION AND REPLACEMENT OF WASTEWATER LIFT STATIONS AND RELATED APPURTENANCES. THESE EASEMENTS MAY BE FENCED IN BY PALM BEACH COUNTY FOR ACCESS CONTROL PURPOSES. THE MAINTENANCE OF THE UNFENCED PORTIONS OF THE LAND UNDERLYING THIS EASEMENT SHALL BE THE PERPETUAL OBLIGATION OF THE PROPERTY OWNER. NO BUILDINGS, STRUCTURES, IMPROVEMENTS, TREES, WALLS OR FENCES SHALL BE INSTALLED WITHIN THIS LIFT STATION EASEMENT WITHOUT PRIOR WRITTEN APPROVAL OF THE PALM BEACH COUNTY WATER UTILITIES DEPARTMENT, ITS SUCCESSORS AND ASSIGNS.

PALM BEACH COUNTY, ITS SUCCESSORS AND ASSIGNS SHALL HAVE VEHICULAR AND PEDESTRIAN ACCESS OVER ALL PUBLICLY ACCESSIBLE AREAS OF TRACTS A AND B FOR THE PURPOSES OF INGRESS, EGRESS AND ACCESS TO PALM BEACH COUNTY OWNED UTILITIES.

8. LIMITED ACCESS EASEMENT (LAE), AS SHOWN HEREON IS HEREBY DEDICATED TO THE VILLAGE OF WELLINGTON, FLORIDA FOR THE PURPOSE OF CONTROL AND JURISDICTION OVER ACCESS RIGHTS.

9. "2008 FLORIDA STATUTES-TITLE XII, CHAPTER 177.101(2); VACATION AND ANNULLMENT OF PLATS SUBDIVIDING LAND. THE FOLLOWING IS STATED, AND APPLIES TO THE UNDERLYING PLATS OF ISLA VERDE OF WELLINGTON, AS RECORDED IN PLAT BOOK 110, PAGES 132 THROUGH 138, AND ISLA VERDE OF WELLINGTON RESIDENTIAL, AS RECORDED IN PLAT BOOK 111, PAGES 200 THROUGH 204, BOTH OF THE PUBLIC RECORDS OF PALM BEACH COUNTY, FLORIDA. "...THE APPROVAL OF A REPLAT BY THE GOVERNING BODY OF A LOCAL GOVERNMENT, WHICH ENCOMPASSES LANDS EMBRACED IN ALL OR IN PART OF A PRIOR PLAT FILED OF PUBLIC RECORD SHALL, UPON RECORDED OF THE REPLAT, AUTOMATICALLY AND SIMULTANEOUSLY VACATE AND ANNULL ALL OF THE PRIOR PLAT ENCOMPASSED BY THE REPLAT."

**DEDICATION AND RESERVATIONS CONTINUED:**  
IN WITNESS WHEREOF, SHOPPES AT ISLA VERDE LTD., A FLORIDA LIMITED PARTNERSHIP HAS CAUSED THESE PRESENTS TO BE SIGNED BY ITS GENERAL PARTNER, ISLA VERDE MANAGEMENT COMPANY, INC., A FLORIDA CORPORATION, THIS 15 DAY OF November 2011.

SHOPPES AT ISLA VERDE LTD.  
A FLORIDA LIMITED PARTNERSHIP  
BY: ISLA VERDE MANAGEMENT COMPANY, INC.  
A FLORIDA CORPORATION,  
ITS GENERAL PARTNER

WITNESS: [Signature]  
PRINT NAME Doreen Haines  
WITNESS: [Signature]  
PRINT NAME Ronnie King

WITNESS: [Signature]  
PRINT NAME Bruce Weiner  
WITNESS: [Signature]  
PRINT NAME Ronnie King

**ACKNOWLEDGMENT:**

STATE OF FLORIDA)  
COUNTY OF PALM BEACH)

BEFORE ME PERSONALLY APPEARED BRUCE WEINER, WHO IS PERSONALLY KNOWN TO ME, OR ~~HAVE PRODUCED~~ AS IDENTIFICATION, AND WHO EXECUTED THE FOREGOING INSTRUMENT AS ~~VICE PRESIDENT~~ PRESIDENT OF ISLA VERDE MANAGEMENT COMPANY, INC., A FLORIDA LIMITED PARTNERSHIP, AND SEVERALLY ACKNOWLEDGED TO AND BEFORE ME THAT HE EXECUTED SUCH INSTRUMENT AS SUCH OFFICER OF SAID CORPORATION, AND THAT THE SEAL AFFIXED TO THE FOREGOING INSTRUMENT IS THE CORPORATE SEAL OF SAID CORPORATION AND THAT IT WAS AFFIXED TO SAID INSTRUMENT BY DUE AND REGULAR CORPORATE AUTHORITY, AND THAT SAID INSTRUMENT IS THE FREE ACT AND DEED OF SAID CORPORATION.

WITNESS MY HAND AND OFFICIAL SEAL THIS 15 DAY OF November 2011.

MY COMMISSION EXPIRES: 12/27/2015 Jennifer Sarver  
NOTARY PUBLIC  
COMMISSION NUMBER: EE 134320 Jennifer Sarver  
PRINT NAME

IN WITNESS WHEREOF, PEBB ENTERPRISES ROYAL PALM BEACH PROPERTY, LLC, HAS CAUSED THESE PRESENTS TO BE SIGNED BY ITS President AND ITS SEAL TO BE AFFIXED HERETO BY AND WITH THE AUTHORITY OF ITS President OF THE COMPANY, THIS 15 DAY OF November 2011.

PEBB ENTERPRISES ROYAL PALM BEACH PROPERTY, LLC  
A FLORIDA LIMITED LIABILITY COMPANY  
BY: [Signature]  
Its Manager Abb Management Company  
Inc. A Florida Corporation  
WITNESS: [Signature]  
PRINT NAME Ronnie King

**ACKNOWLEDGMENT:**

STATE OF FLORIDA)  
COUNTY OF Palm Beach)

BEFORE ME PERSONALLY APPEARED Bruce Weiner WHO IS PERSONALLY KNOWN TO ME, OR ~~HAVE PRODUCED~~ AS IDENTIFICATION, AND WHO EXECUTED THE FOREGOING INSTRUMENT AS ~~VICE PRESIDENT~~ President OF PEBB ENTERPRISES ROYAL PALM BEACH PROPERTY, LLC, A FLORIDA LIMITED LIABILITY COMPANY AND SEVERALLY ACKNOWLEDGED TO AND BEFORE ME THAT HE EXECUTED SUCH INSTRUMENT AS SUCH OFFICER OF SAID CORPORATION, AND THAT THE SEAL AFFIXED TO THE FOREGOING INSTRUMENT IS THE CORPORATE SEAL OF SAID CORPORATION AND THAT IT WAS AFFIXED TO SAID INSTRUMENT BY DUE AND REGULAR COMPANY AUTHORITY, AND THAT SAID INSTRUMENT IS THE FREE ACT AND DEED OF SAID COMPANY.

WITNESS MY HAND AND OFFICIAL SEAL THIS 15 DAY OF November 2011.

MY COMMISSION EXPIRES: 12/27/2015 Jennifer Sarver  
NOTARY PUBLIC  
COMMISSION NUMBER: EE 134320 Jennifer Sarver  
PRINT NAME

**ACCEPTANCE OF DEDICATIONS:**

STATE OF FLORIDA)  
COUNTY OF PALM BEACH)

THE ISLA VERDE OF WELLINGTON MASTER ASSOCIATION, INC., A FLORIDA CORPORATION NOT FOR PROFIT, HEREBY ACCEPTS THE DEDICATIONS TO SAID ASSOCIATION AS STATED AND SHOWN HEREON, AND HEREBY ACCEPTS ITS MAINTENANCE OBLIGATIONS FOR SAME AS STATED HEREON, DATED THIS 15 DAY OF November 2011.

ISLA VERDE OF WELLINGTON  
MASTER ASSOCIATION, INC.  
A FLORIDA CORPORATION  
NOT FOR PROFIT  
BY: [Signature]  
BRUCE WEINER  
PRESIDENT

WITNESS: [Signature]  
PRINT NAME Doreen Haines  
WITNESS: [Signature]  
PRINT NAME Ronnie King

**ACKNOWLEDGMENT:**

STATE OF FLORIDA)  
COUNTY OF PALM BEACH)

BEFORE ME PERSONALLY APPEARED BRUCE WEINER, WHO IS PERSONALLY KNOWN TO ME, OR ~~HAVE PRODUCED~~ AS IDENTIFICATION, AND WHO EXECUTED THE FOREGOING INSTRUMENT AS ~~VICE PRESIDENT~~ PRESIDENT OF ISLA VERDE OF WELLINGTON MASTER ASSOCIATION, INC., A FLORIDA CORPORATION NOT FOR PROFIT, AND SEVERALLY ACKNOWLEDGED TO AND BEFORE ME THAT HE EXECUTED SUCH INSTRUMENT AS SUCH OFFICER OF SAID ASSOCIATION, AND THAT THE SEAL AFFIXED TO THE FOREGOING INSTRUMENT IS THE CORPORATE SEAL OF SAID ASSOCIATION AND THAT IT WAS AFFIXED TO SAID INSTRUMENT BY DUE AND REGULAR CORPORATE AUTHORITY, AND THAT SAID INSTRUMENT IS THE FREE ACT AND DEED OF SAID CORPORATION.

WITNESS MY HAND AND OFFICIAL SEAL THIS 15 DAY OF November 2011.

MY COMMISSION EXPIRES: 12/27/15 Jennifer Sarver  
NOTARY PUBLIC  
COMMISSION NUMBER: EE 134320 Jennifer Sarver  
PRINT NAME

**MORTGAGEES CONSENT:**

STATE OF FLORIDA)  
COUNTY OF )

THE UNDERSIGNED HEREBY CERTIFIES THAT IT IS THE HOLDER OF A MORTGAGE, UPON THE PROPERTY DESCRIBED HEREON AND DOES HEREBY JOIN IN AND CONSENT TO THE DEDICATION OF THE LAND DESCRIBED IN SAID DEDICATION BY THE OWNER THEREOF AND AGREES THAT ITS MORTGAGE WHICH IS RECORDED IN OFFICIAL RECORDS BOOK 22547, AT PAGE 406 OF THE PUBLIC RECORDS OF PALM BEACH COUNTY, FLORIDA, SHALL BE SUBORDINATED TO THE DEDICATION SHOWN HEREON.

IN WITNESS WHEREOF, THE SAID CORPORATION HAS CAUSED THESE PRESENTS TO BE SIGNED BY ITS ~~VICE PRESIDENT~~ VICE PRESIDENT AND ITS CORPORATE SEAL TO BE AFFIXED HERETO BY AND WITH THE AUTHORITY OF ITS BOARD OF DIRECTORS THIS 14 DAY OF November 2011.

SUNTRUST BANK  
A BANKING CORPORATION AUTHORIZED  
TO DO BUSINESS IN FLORIDA  
BY: [Signature]  
VICE PRESIDENT  
WITNESS: [Signature]  
PRINT NAME Ann Malino  
WITNESS: [Signature]  
PRINT NAME Robson Thompson Singh

**ACKNOWLEDGMENT:**

STATE OF FLORIDA)  
COUNTY OF )

BEFORE ME PERSONALLY APPEARED Joyce Werzer WHO IS PERSONALLY KNOWN TO ME OR HAS PRODUCED [Signature] AS IDENTIFICATION, AND WHO EXECUTED THE FOREGOING INSTRUMENT AS VICE PRESIDENT OF SUNTRUST BANK, A BANKING CORPORATION AUTHORIZED TO DO BUSINESS IN FLORIDA, AND SEVERALLY ACKNOWLEDGED TO AND BEFORE ME THAT HE EXECUTED SUCH INSTRUMENT AS SUCH OFFICER OF SAID COMPANY, AND THAT THE SEAL AFFIXED TO THE FOREGOING INSTRUMENT IS THE CORPORATE SEAL OF SAID COMPANY AND THAT IT WAS AFFIXED TO SAID INSTRUMENT BY DUE AND REGULAR CORPORATE AUTHORITY, AND THAT SAID INSTRUMENT IS THE FREE ACT AND DEED OF SAID COMPANY.

WITNESS MY HAND AND OFFICIAL SEAL THIS 14TH DAY OF November 2011.

MY COMMISSION EXPIRES: DD 758610 Nonda Applegate  
NOTARY PUBLIC  
COMMISSION NUMBER: 3/23/12 Nonda Applegate  
PRINT NAME

SHOPPES AT ISLA VERDE LTD. NOTARY  
PEBB ENTERPRISES ROYAL PALM BEACH PROPERTY, LLC NOTARY  
ISLA VERDE MANAGEMENT COMPANY, INC. NOTARY  
ISLA VERDE OF WELLINGTON MASTER ASSOCIATION, INC. NOTARY  
BANK NOTARY  
VILLAGE OF WELLINGTON NOTARY  
VILLAGE OF WELLINGTON ENGINEER  
SURVEYOR